

THE INFORMATION AND DESIGN HEREIN WAS ORIGINATED BY AND IS THE PROPERTY OF SKYLOCK INDUSTRIES INCORPORATED. SKYLOCK INDUSTRIES INCORPORATED RESERVES ALL PATENT, PROPRIETARY, DESIGN MANUFACTURING, REPRODUCTION, USE AND SALES RIGHTS THERE TO, AND TO ANY ARTICLE DISCLOSED THEREIN EXCEPT TO THE EXTENT RIGHTS ARE EXPRESSLY GRANTED TO OTHERS. THE FOREGOING DOES NOT APPLY TO VENDOR PROPRIETARY PARTS.

REVISIONS				
ZONE	LTR	DESCRIPTION	DATE	APPROVED
	E	SEE ECN E		

- .91 BOLT PROJECTION (FOR -1 ONLY)
- .81 BOLT PROJECTION (FOR -3 ONLY)
- 1.12 BOLT PROJECTION (FOR -5 ONLY)
- .91 BOLT PROJECTION (FOR -7 ONLY)
- 1.00 BOLT PROJECTION (FOR -11 ONLY)
- 1.06 BOLT PROJECTION (FOR -13 ONLY)

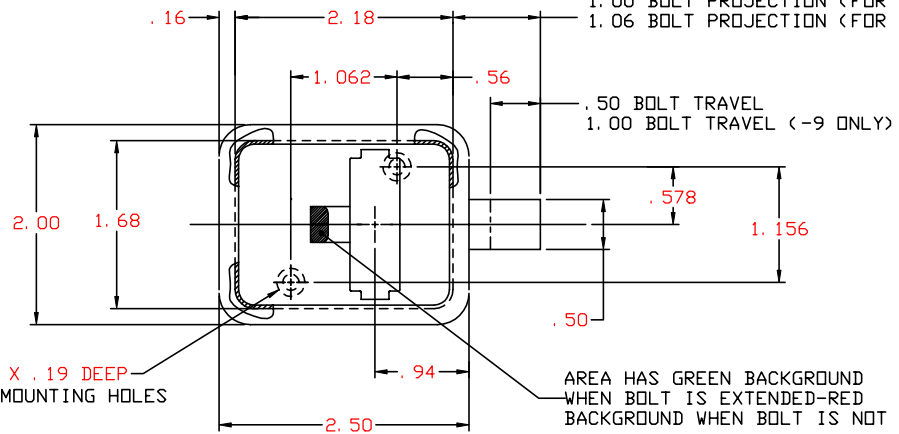

NO. 8-32 X .19 DEEP
MIN. MOUNTING HOLES
2 PL

AREA HAS GREEN BACKGROUND
WHEN BOLT IS EXTENDED-RED
BACKGROUND WHEN BOLT IS NOT FULLY LATCHED.

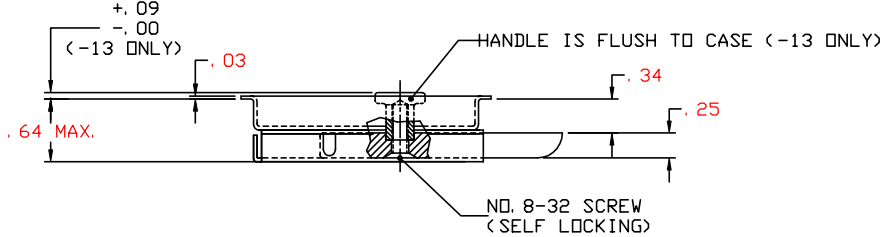

-1, -5, -9, -11, -13 LATCH (SHOWN)

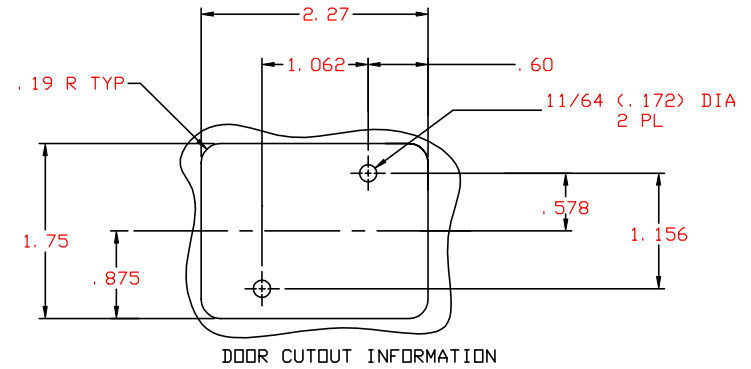

DOOR CUTOUT INFORMATION

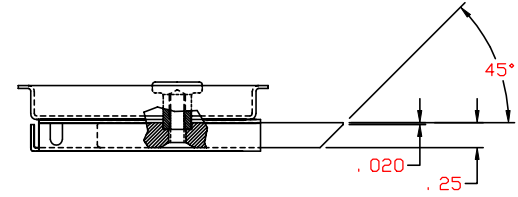

-3 & -7 LATCH
(SAME AS -1 EXCEPT AS SHOWN)

7. APPLICABLE TO FAA-PMA REPLACEMENT OR MODIFICATION PARTS ONLY. PER FAR 45.15, PARTS WILL BE IDENTIFIED WITH:
1. FAA-PMA.
 2. SKYLOCK IND. INC.
 3. PART NO.
 4. AIRCRAFT INSTALLATION ELIGIBILITY.

- ⚠ BOLT IS SPRING LOADED AND ALWAYS FREE TO LATCH.
- ⚠ BOLT IS DETENTED IN EXTENDED AND RETRACTED POSITION.

4. THE FOLLOWING STATIC LOAD IS FOR REFERENCE USE ONLY. IT IS PROVIDED FOR CUSTOMER ENGINEERING TO DETERMINE THE GENERAL SUITABILITY OF THE PRODUCT FOR ITS INTENDED USE. ALTHOUGH SKYLOCK IS PROVIDING THE REFERENCE STATIC LOAD, THE CUSTOMER IS ULTIMATELY RESPONSIBLE FOR CERTIFICATION OF THE PRODUCT FOR ITS SPECIFIC APPLICATION. REFERENCE STATIC LOAD: 600 LBS. MAX.

3. DECORATIVE FINISH REF.: SATIN BUFF LENGTHWISE TO PART SURFACE.

⚠ FINISH REF.: HANDLE; CLEAR ANODIZE PER MIL-A-8625, TYPE II, CLASS 1, OR EQUIV. CRES PARTS; PASSIVATE PER AMS-QQ-P-35, TYPE II, OR EQUIV.

⚠ MATL REF.: HANDLE; 6061-T6/T651, PER ASTM B-221, OR EQUIV. ALL OTHER PARTS; 303 CRES, COND. A, PER AMS-5640N OR EQUIV.

REMOVE ALL BURRS AND SHARP CORNERS.

NOTES: UNLESS OTHERWISE SPECIFIED

QTY REQD	PART NO.	DESCRIPTION	MATERIAL	SIZE	APPLICATION	MAKE FROM
	-13	LATCH-DETENTED	⚠ ⚠ ⚠			120066-13
	-11	LATCH-DETENTED	⚠ ⚠ ⚠			120066-11
	-9	LATCH-DETENTED	⚠ ⚠ ⚠			120066-9
	-7	LATCH-SPRING LOADED	⚠ ⚠ ⚠			120066-7
	-5	LATCH-DETENTED	⚠ ⚠ ⚠			120066-5
	-3	LATCH-SPRING LOADED	⚠ ⚠ ⚠			120066-3
	-1	LATCH-DETENTED	⚠ ⚠ ⚠			120066-1

PARTS LIST		UNLESS OTHERWISE SPECIFIED		DRAWN BY M FOSTER		SKYLOCK INDUSTRIES INCORPORATED MONROVIA CALIFORNIA U. S. A.	
DIMENSIONS ARE IN INCHES		CHECKED		ENGINEER		20066 LATCH	
TOLERANCES ON		MFG		QC			
DECIMALS ANGLES DRILLED HOLES							
.X ± .1 ± 0° 30' AND 10387							
.XXX ± .03							
.XXX ± .010							
DO NOT SCALE THIS DRAWING							
MATERIAL - FINISH		USED ON		SIZE	CODE IDENT. NO.	DRAWING NO.	REV.
NEXT ASSY				C	51941	20066	E
MANUFACTURE IN ACCORDANCE WITH SKYLOCK IND. INC., QUALITY CONTROL MANUAL QC.001				SCALE	1:1	WT.	SHEET 1 OF 1