

THE INFORMATION AND DESIGN HEREIN WAS ORIGINATED BY AND IS THE PROPERTY OF SKYLOCK INDUSTRIES INCORPORATED. SKYLOCK INDUSTRIES INCORPORATED RESERVES ALL PATENT, PROPRIETARY, DESIGN MANUFACTURING, REPRODUCTION, USE AND SALES RIGHTS THERETO, AND TO ANY ARTICLE DISCLOSED THEREIN EXCEPT TO THE EXTENT RIGHTS ARE EXPRESSLY GRANTED TO OTHERS. THE FOREGOING DOES NOT APPLY TO VENDOR PROPRIETARY PARTS.

REVISIONS				
ZONE	LTR.	DESCRIPTION	DATE	APPROVED
	NC	PRODUCTION RELEASE	8.14.91	SC
	A	REVISED BACKPLATE FINISH	9.5.91	SC

NOTES: UNLESS OTHERWISE SPECIFIED

1. REMOVE ALL BURRS AND SHARP EDGES
2. MAT'L: CASE AND BACKPLATE; ALUM ALLOY
3. FINISH: CASE; SATIN BRUSH AND CLEAR ANODIZE PER MIL-A-8625E; BACKPLATE; GEORGIAN GREY WRINKLE POWDER COAT, MORTON 12-7002

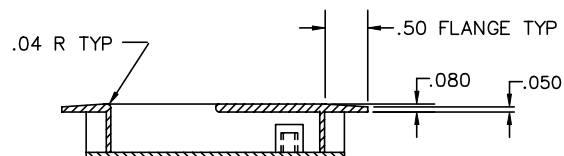
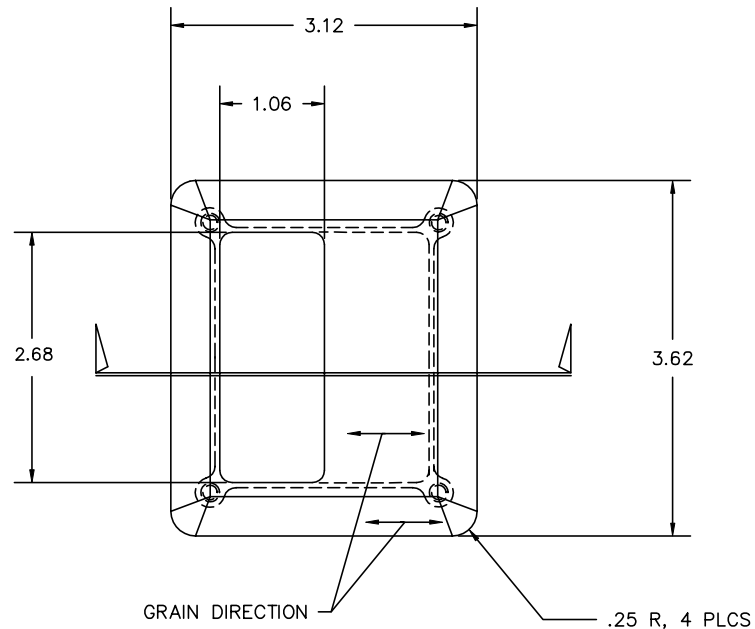
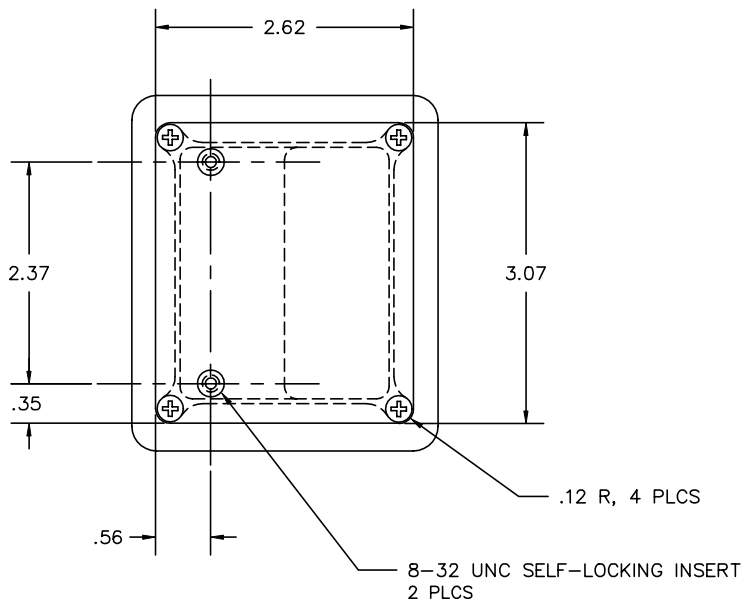

.68		-3	HANDLE ASSY		
.48		-1	HANDLE ASSY		
A	QTY. REQ'D	PART / IDENT NO.	DESCRIPTION	MATERIAL / SPECIFICATION	ITEM NO.
	UNLESS OTHERWISE SPECIFIED: DIMENSIONS ARE IN INCHES		CONTRACT NO.	 SKYLOCK INDUSTRIES INCORPORATED MONROVIA, CALIFORNIA, USA	A
	TOLERANCES		CUSTOMER		
	DECIMALS	ANGULAR	DRAWN BY	DATE	HANDLE ASSY
	.XX ±.03	± 0 30'	S. CSIK		
	.XXX ±.010		CHECK		
	DO NOT SCALE DRAWING		DESIGN		
	NEXT ASSY	FINAL ASSY	DESIGN ACTIVITY	SIZE	REV.
	USED ON			C	A
	FINISH	ACT WT	CALC WT	FSCM NO.	DRAWING NO.
				51941	20720
				SCALE 1/1	RELEASE DATE 8.14.91
					SHEET 1 OF 1