

THE INFORMATION AND DESIGN HEREIN WAS ORIGINATED BY AND IS THE PROPERTY OF SKYLOCK INDUSTRIES INCORPORATED. SKYLOCK INDUSTRIES INCORPORATED RESERVES ALL PATENT, PROPRIETARY, DESIGN MANUFACTURING, REPRODUCTION, USE AND SALES RIGHTS THERE TO, AND TO ANY ARTICLE DISCLOSED THEREIN EXCEPT TO THE EXTENT RIGHTS ARE EXPRESSLY GRANTED TO OTHERS. THE FOREGOING DOES NOT APPLY TO VENDOR PROPRIETARY PARTS.

REVISIONS				
ZONE	LTR	DESCRIPTION	DATE	APPROVED
	NC	PRODUCTION RELEASE	3-30-92	T. CSIK
	A	REVISED DIM. IS .56/.58 WAS .62	5-26-92	T. CSIK
	B	ADDED -403	7-16-92	T. CSIK
	C	ADDED -405	2-8-93	T. CSIK
	D	REVISED NOTE 5	7-10-97	T. CSIK
	E	SEE ECN E	3/5/99	T. CSIK

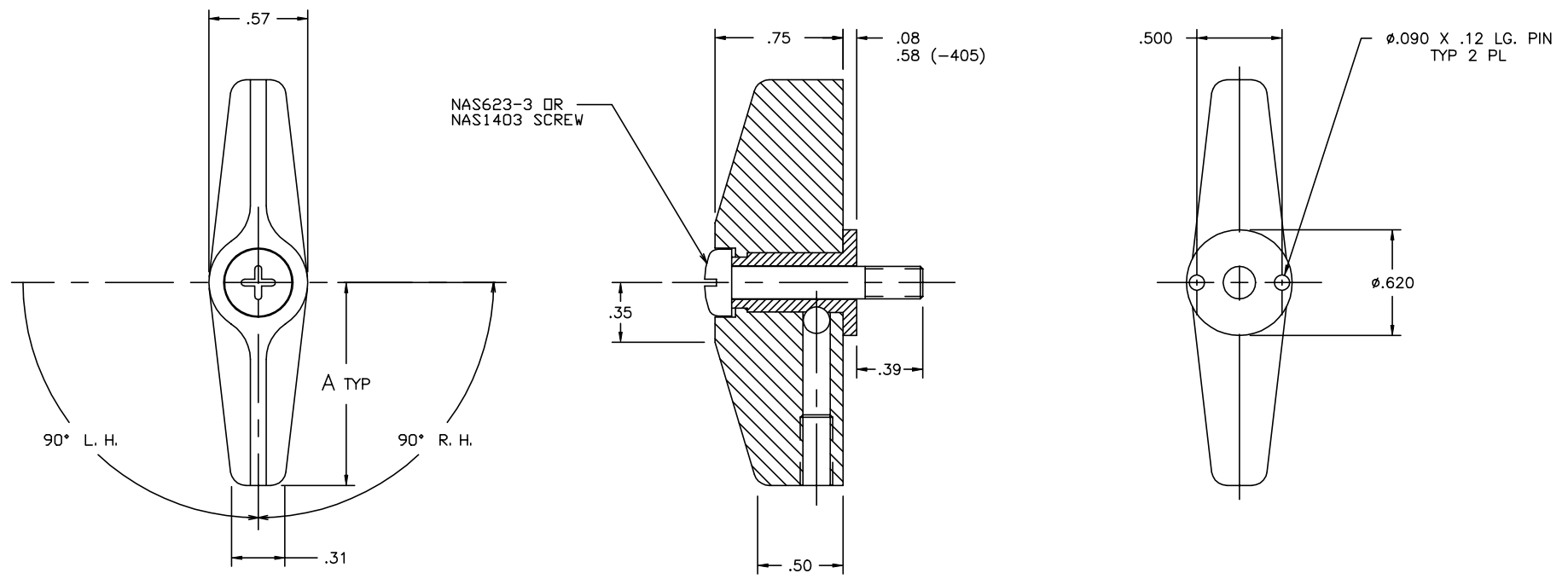

5. REMOVED
4. DECORATIVE FINISH: RETAINER; BRIGHT POLISH AND ANODIZE PER MIL-A-8625, TYPE II, CLASS 2, DYED CANDY APPLE RED.
3. FINISH: ALUM.; CLEAR ANODIZE PER MIL-A-8625, TYPE II, TYPE 1. CRES PARTS, PASSIVATE PER AMS-QQ-P-35, TYPE II.
2. MAT'L: RETAINER; ALUM. ALLOY, 7075-T6/T651 PER ASTM B-221 OR EQUIV. ALL OTHER PARTS; 303 CRES, CONDITION A, PER AMS-5640N OR EQUIV.
1. REMOVE ALL BURRS AND SHARP CORNERS

NOTES: UNLESS OTHERWISE SPECIFIED:

2.00	-405	RETAINER ASSY	(90° LEFT HAND)	
2.00	-403	RETAINER ASSY	(90° LEFT HAND)	
1.19	-402	RETAINER ASSY	(90° RIGHT HAND)	
1.19	-401	RETAINER ASSY	(90° LEFT HAND)	

A DIM	PART NO.	DESCRIPTION	MATERIAL	SIZE	APPLICATION	ITEM NO.
PARTS LIST						
UNLESS OTHERWISE SPECIFIED			DRAWN BY T. CSIK 3-30-92			
DIMENSIONS ARE IN INCHES			CHECKED T. CSIK 3/5/99			
TOLERANCES ON			ENGINEER T. CSIK 3/5/99			
DECIMALS ANGLES DRILLED HOLES			MFG P. MATSUOKA 3/15/99			
.X .1 0° 30' AND 10387			Q.A. J. VIVIRITO 3/18/99			
.XX .03						
.XXX .010						
DO NOT SCALE THIS DRAWING						
MATERIAL - FINISH		USED ON		SIZE	CODE IDENT. NO.	DRAWING NO.
NEXT ASSY				C	51941	20766
FINAL ASSY				SCALE	2:1	WT. SHEET 1 OF 1

SKYLOCK INDUSTRIES INCORPORATED
MONROVIA CALIFORNIA U. S. A.

1/4 TURN RETAINER

REV.	E
SCALE	2:1
WT.	
SHEET	1 OF 1